

Liquid Filled Pressure Gauges (GO Series)

<HSI>
Pressure/ Temperature Instrument

Summary

- 충격 및 진동 적용
- 비 부식성 가스, 공기, 오일 및 물
- 유압 시스템 및 공작 기계
- 석유 화학 처리 장비
- 펌프, 컴프레서 및 레귤레이터
- 황동에 반응하지 않는 물질

Standard features

Diameter

60, 75 and 100mm

Accuracy

60, 75mm : $\pm 1.5\%$ of Full Scale

100mm : $\pm 1.5\%$ of Full Scale

Scale Range

60, 75mm : -0.1 ~ 2 MPa, 0 ~ 25 MPa

100mm : -0.1 ~ 2 MPa, 0 ~ 100 MPa

Process connection

60mm : PT,PF,NPT - 1/4", UNF

75mm : PT,PF,NPT - 3/8", UNF

100mm : PT,PF,NPT - 3/8", 1/2", UNF

Material

Case, Cover : STS 304

Window : Safety Glass

Connection : Brass (C3604BE) - Cr Plating

Element : Brass (C2700T)

Movement : STS304

Filling liquid: Silicon Oil, Glycerine Oil

GO Series (Type A)



Pressure Gauge

Temperature Gauge

Temperature Element

Pressure Limitation

Steady : 3/4 of full scale (75%)

Fluctuating : 3/5 of full scale (60%)

Operating Temperature

Ambient : -20 ~ 65°C

Media(Fluid) : -20 ~ 40°C

Option

Test Report by Manufacturer

Test Report by KOLAS

USE NO OIL

Liquid Filled Pressure Gauges (GO Series)

<HSI>

Pressure/ Temperature Instrument

Type of Mounting

TYPE - A

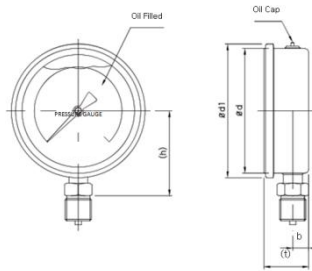

TYPE - B

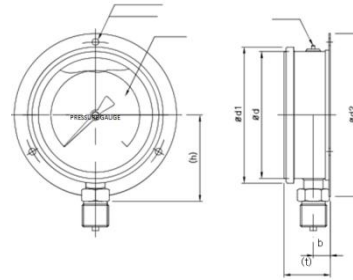

TYPE - D

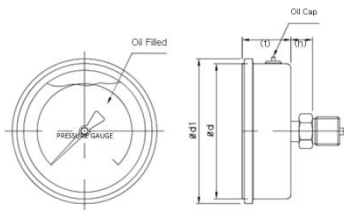

TYPE - BD

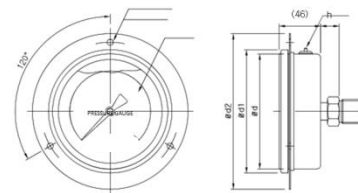

Pressure Gauge

Temperature Gauge

Temperature Element

| Dial | Model | Ød | Ød1 | Ød2 | b | n | t | h | Øh | Ød |
|------|-------|-----|-----|-----|----|---|----|----|-----|-----|
| 60 | A,B | 63 | 72 | 84 | 10 | - | 34 | 46 | 4.5 | 72 |
| | D,BD | | | 90 | - | - | | 13 | | 81 |
| 75 | A,B | 77 | 86 | 100 | 14 | - | 36 | 57 | 4.5 | 88 |
| | D,BD | | | 107 | - | - | | 16 | | 97 |
| 100 | A,B | 100 | 107 | 128 | 14 | - | 46 | 68 | 5.5 | 115 |
| | D,BD | | | 135 | - | - | | 16 | | 120 |