

# Industrial Service Bimetal Thermometer (LR Series)

<HSI>

Pressure/ Temperature Instrument

## Summary

- 부식성 매체
- 화학, 석유, 식품 산업
- 기계 및 플랜트 엔지니어링
- 배관 및 산업용 난방시설

## Standard features

### Diameter

50,65mm

### Accuracy

50,65mm :  $\pm 2.0$  of Full Scale

### Scale Range

50,65mm : -50 ~ 650°C

### Process connection

50,65mm : PT,PF,NPT - 1/4", 3/8", 1/2", 1"

### Material

Case : 304SS

Cover : 304SS

Window : General Glass

Connection : 304SS, 316SS

Stem : 304SS, 316SS

Element : Bimetal Coiled

Pointer : Black Aluminum

## Temperature Element

Bimetal Coiled

## LR Series



## Common Temperature

75% of Full Scale

## Option

Test Report by Manufacturer

Test Report by KOLAS

High Accuracy

OEM Service for a specific customer

Pressure Gauge

Temperature Gauge

Temperature Element

# Industrial Service Bimetal Thermometer (LR Series)

<HSI>

Pressure/ Temperature Instrument

## Type of Mounting

### LR Series

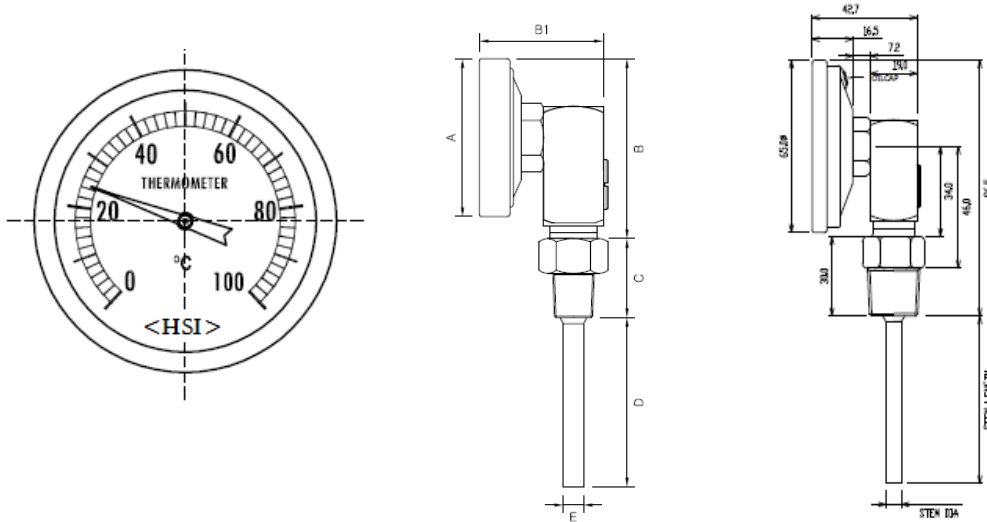

Model	Dial	A	B	C	D	F
LR	50	50.0	57/B1-39.5	25	Max 1000L	4, 5, 6.4, 8 Standard 6.4Ø
	65	65.0	96.5	30		

온도범위	1눈금 온도	제작가능 최소길이 (6.4Ø)	
		50Ø	65Ø
0~50℃	1	60	60
0~100℃	2	45	50
0~150℃	5	45	40
0~200℃	5	30	30
0~250℃	5	30	30
0~300℃	5	50	50
0~350℃	5	50	50
0~400℃	10	60	60
0~500℃	10	60	60
0~600℃	10	60	60
-50~50℃	2	-	-
-30~50℃	2	-	-
-30~100℃	5	-	-
-20~50℃	2	-	-
-20~100℃	2	-	-

Pressure Gauge

Temperature Gauge

Temperature Element