

General Service Pressure Gauges (GP Series)

<HSI>

Pressure/ Temperature Instrument

Summary

- 비 부식성 가스, 공기, 오일 및 물
- 공압, 진공 장비
- 컴프레셔의 공기 및 가스 압력 모니터링
- 펌프 및 레귤레이터
- 의료용 가스 실린더
- 황동에 반응하지 않는 물질

Standard features

Diameter

40, 50, 60, 75, 100, 150, and 200mm

Accuracy

40mm : ± 3.0 of Full Scale

50mm : ± 3.0 or ± 1.5 of Full Scale

60,75,100,150,200mm : ± 1.5 of Full Scale

Scale Range

40,50mm : 0.2 ~ 5 MPa

60,75mm : -0.1 ~ 2 MPa, 0 ~ 35 MPa

100,150mm : -0.1 ~ 2 MPa, 0 ~ 100 MPa

200mm : -0.1 ~ 2 MPa, 0 ~ 5 MPa

Process connection

40,50mm : PT,PF,NPT - 1/8"

60,75mm : PT,PF,NPT - 1/4"

100mm : PT,PF,NPT - 3/8", 1/2"

150mm,200mm : PT,PF - 3/8"

Material

Case, Cover : Steel (SPCD), Black Coating

Window : General Glass

Connection : Brass

Element : Brass (C2700T)

Movement : Brass

GP Series (Type A)



Pressure Gauge

Temperature Gauge

Temperature Element

Pressure Limitation

Steady : 3/4 of full scale (75%)

Fluctuating : 3/5 of full scale (60%)

Operating Temperature

Ambient : -20 ~ 65°C

Media(Fluid) : -20 ~ 40°C

Option

Test Report by Manufacturer

Test Report by KOLAS

USE NO OIL

General Service Pressure Gauges (GP Series)



Pressure/ Temperature Instrument

Type of Mounting

TYPE - A

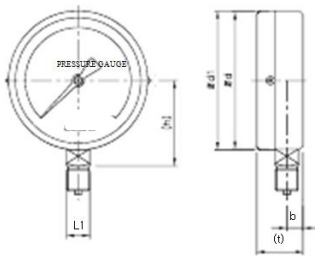

TYPE - B

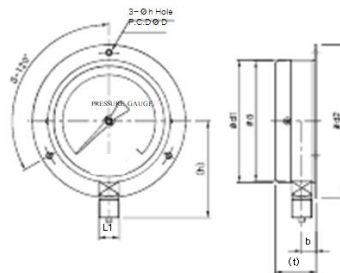

TYPE - L

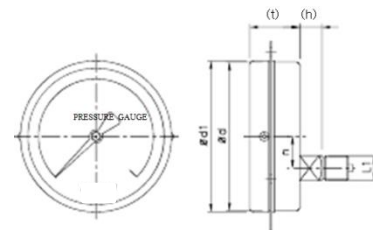

TYPE - BL

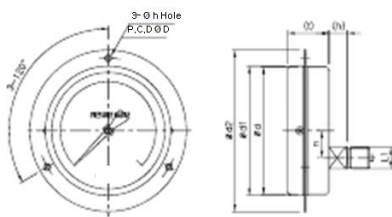

TYPE - D

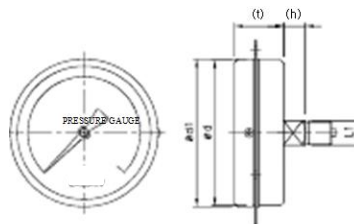

TYPE - BD

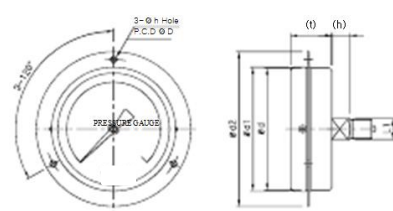

Pressure Gauge

Temperature Gauge

Temperature Element

Dial	Model	Ød	Ød1	Ød2	b	n	t	L1	H	Øh	Ød
40	A	41	42	-	8	-	24	12	30	-	-
	D			-	-	-	26		9		
63	A	51.5	53	-	9.5	-	30	14	36	-	-
	D			-	-	-			10		
60	A,B	62	63	80	10.5	-	33	14	40	4.5	72
	D,BD			-	-	-			10		
75	A,B	76	78	100	12	-	35	17	52	4.5	88
	D,BD			-	-	-			14		
100	A,B	100	102	128	17	-	36	22	63	5.5	115
	BL,L			-	33	-			15		
150	A,B	152	153	188	17	-	41	22	94	5.5	174
	BL,L			-	33	-			24		
200	B	198	200	234	17.5	-	50	22	117	5.5	220